

Lebanese Red Cross Center

Qab Elias



CLADDING GUIDELINES FOR THE LEBANESE RED CROSS CENTER IN QAB ELIAS

Lebanese Red Cross Center

Qab Elias



Stone capping to
parapet

60 cm Drop in
cladding over
steel support

Stone
cladding

Stone cap to parapet

Stone tiling to stairs
and ramp



Lebanese Red Cross Center

Qab Elias



Stone
capping to
parapet

Stone
cladding

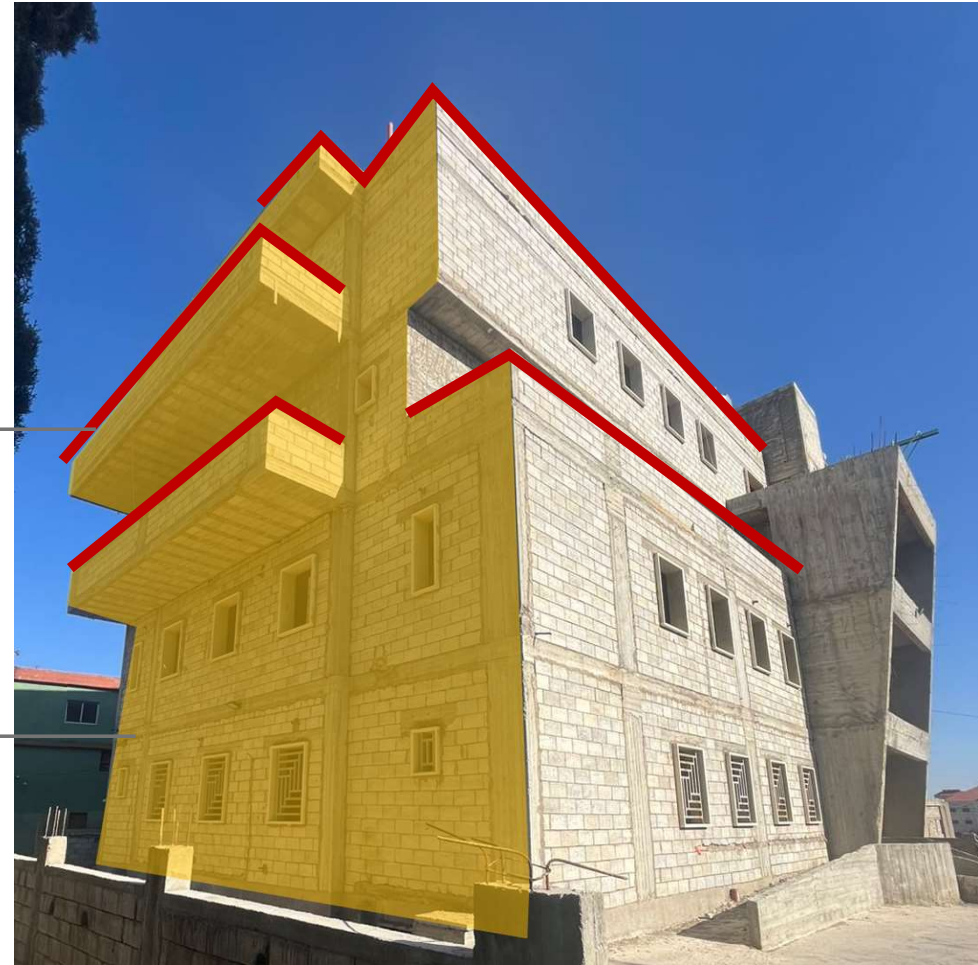

Lebanese Red Cross Center

Qab Elias



Stone capping to
parapet

60 cm Drop in
cladding over
steel support

Stone
cladding

Aluminium flashing
L shape



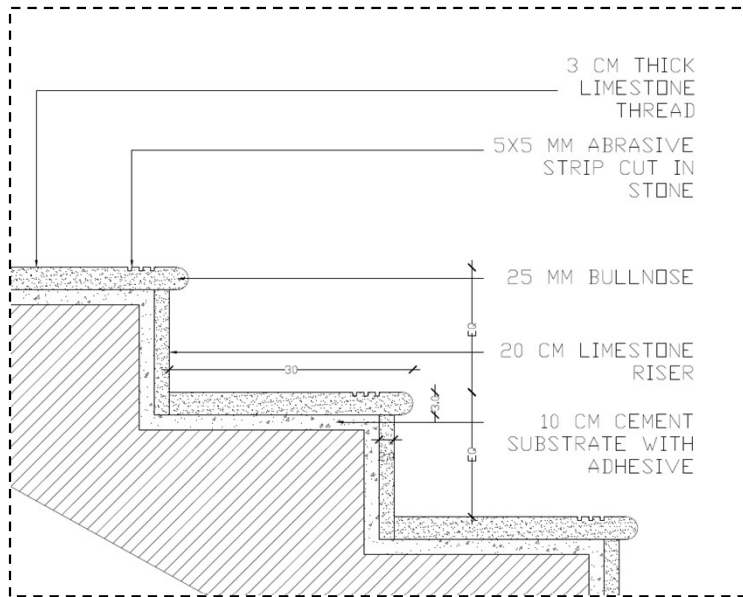

Typical Detail for stairs tiling

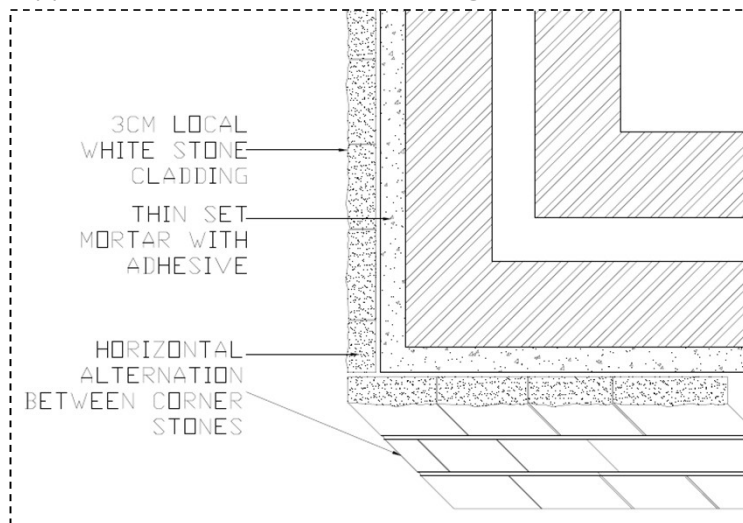

Typical Detail for cladding at corners

Lebanese Red Cross Center Qab Elias



Stone capping to
parapet

60 cm Drop in
cladding over
steel support

Stone
cladding

Stone tiling
to stairs

